

**SIN DANE**

# Standard punch T type(T)

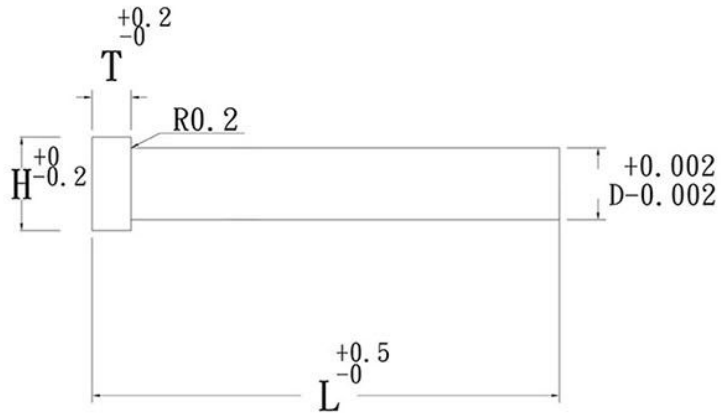

style name:

TD \* L \* quantity

★Semi-finished products are available.

Size/SKD11	50L	60L	70L	80L	90L	100L	Size/SKH51	50L	60L	70L	80L	90L	100L
1.0~2.0	★	★	★				1.0~2.0	★	★				
2.1~3.0	★	★	★				2.1~3.0	★	★	★			
3.1~4.0	★	★	★				3.1~4.0	★	★	★	★	★	
4.1~5.0	★	★	★	★	★	★	4.1~5.0	★	★	★	★	★	★
5.1~6.0	★	★	★	★	★	★	5.1~6.0	★	★	★	★		
6.1~8.0	★	★	★	★	★	★	6.1~8.0	★	★	★	★		
8.1~9.0	★	★	★	★	★	★	8.1~9.0	★	★	★	★		
9.1~10.0	★	★	★	★	★	★	9.1~10.0	★	★	★	★	★	★
10.1~11.0	★	★	★	★	★		10.1~11.0	★	★	★	★		
11.1~12.0	★	★	★	★	★		11.1~12.0	★	★	★	★		
12.1~13.0	★	★	★	★	★		12.1~13.0	★	★	★	★		
13.1~14.0	★	★	★				13.1~14.0	★	★	★			
14.1~15.0	★	★	★				14.1~15.0	★	★	★			
15.1~16.0	★	★	★				15.1~16.0	★	★	★			
16.1~17.0	★	★	★				16.1~17.0	★	★	★			
17.1~18.0	★	★	★				17.1~18.0	★	★	★			
18.1~19.0	★	★	★				18.1~19.0	★	★	★			
19.1~20.0	★	★	★				19.1~20.0						

**Notes:**

1.If the above dimensional tolerances are changed, change processing fees are to be charged separately.

★If not in the standard sizes above, please provide drawings when ordering.Thank you.