

# SIN DANE Standard punch A type(A)

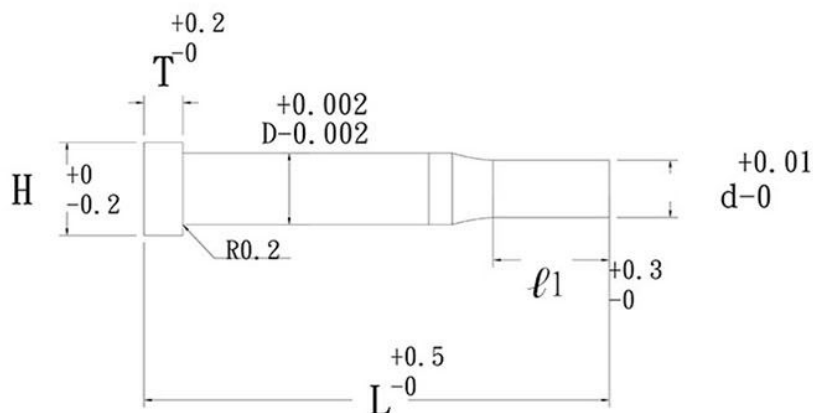

style name :

AD \* d/  $\ell 1$  \* L \* quantity

Code	D	H	T	d	$\ell 1$	L
A	3	5	4	1.0~1.5	10	50 60 70
				1.6~1.9		50 60 70
				2.0~2.9		50 60 70
	4	6	4	1.0~1.5	12	50 60 70
				1.6~1.9		50 60 70
				2.0~2.9		50 60 70
				3.0~3.9		50 60 70
	5	7	4	2.0~2.9	12	50 60 70
				3.0~3.9		50 60 70
				4.0~4.9		50 60 70
	6	8	4	2.0~2.9	12	50 60 70
				3.0~3.9		50 60 70
				4.0~4.9		50 60 70
				5.0~5.9		50 60 70
	8	10	5	3.0~3.9	15	50 60 70
				4.0~4.9		50 60 70
				5.0~7.9		66 60 70
	10	12	5	4.0~4.9	15	50 60 70
				5.0~5.9		50 60 70
				6.0~9.9		50 60 70
13	15	5	8.0~12.9	18~20	50 60 70	

## Notes:

1.Extra fees apply if the size of the notch is less than 1.0, regardless of the size of the plywood.

2.Price will be recalculated if size specifications are changed.

★If not in the standard sizes above, please provide drawings when ordering.Thank you.