

Dowel pin-type with burring (PINM)

Material: S45C

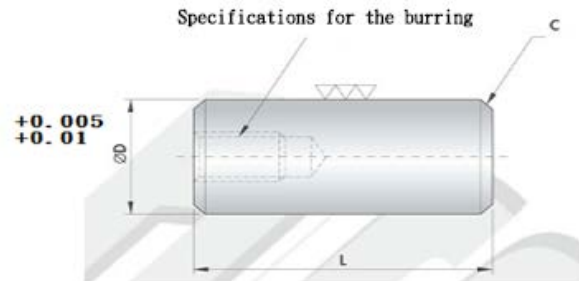

D		K	M	L														
Diameter	Allowable tolerance	Effective length of the burring	Specifications for the burring	Total length														
6	+0.005	9	M4*P0.7	20	25	30	35	40		50	60							
8			M5*P0.8	20	25	30	35	40	45	50	60	70	80					
10	~ +0.01	10	M6*P1.0	20	25	30	35	40	45	50	60	70	80	90	100			
12		13	M8*P1.25			30		40		50	60	70	80	90	100			
14								40		50	60		80					
16				15					40		50	60	70	80				